

Item 109-101-R1100
Attachment

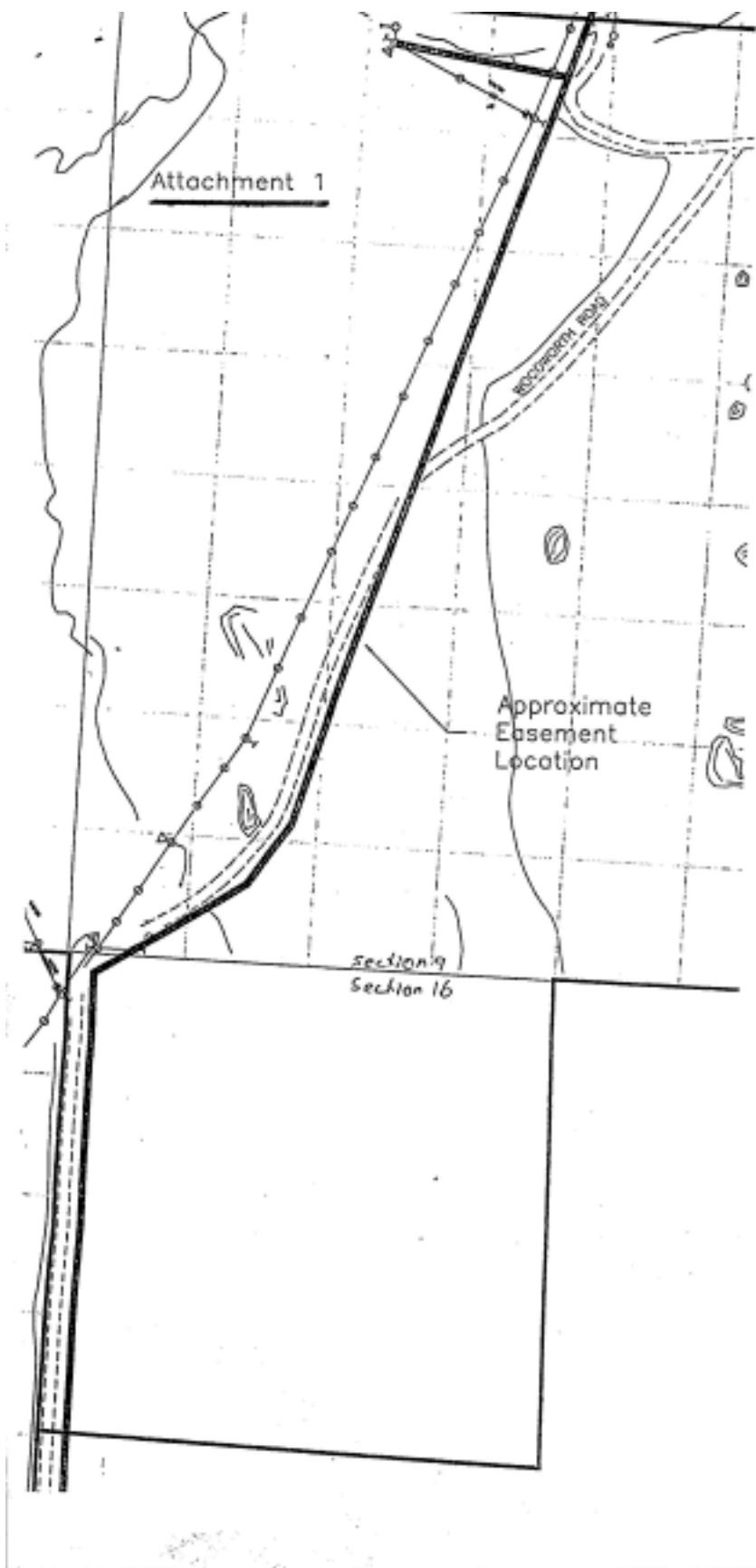

County Powell
Map 15-13-2, 16-15-5 Sections 8 & 16
W/O 200214

CONVEYANCE OF EASEMENT FOR RIGHT OF WAY, known all men by these presents:
That We The University of Montana of Missoula, Missoula County, State of Montana, in consideration of one dollar (\$1.00), and other valuable consideration, the receipt whereof is hereby acknowledged, do hereby grant, warrant and convey unto the Missoula Electric Cooperative, Inc., a corporation, whose address is 1700 West Broadway, Missoula, Montana, and to its successors and assigns, the right, privilege and authority to enter in and upon lands situated in the County Powell, State of Montana, and describe as follows: A strip of land 20 feet wide across the land which the undersigned own or which the undersigned have any interest in,

to wit: description,
W1/2 of Section 9 and W1/2 NW1/4 of Section 16, T15N R13W PMM. Beginning at the north section line at a point west of and adjacent to Woodworth Road and proceeding southerly approximately 1/2 mile to a crossing of Woodworth Road then proceeding parallel and adjacent to Woodworth Road to the NW1/4 section line of Section 16. Centerline of easement to be the center of the MEC overhead power line except when parallel and adjacent to Woodworth Road.

To wit: illustration,

See attachment 1

together with the following rights: Of ingress and egress to, from and along lands adjacent to said strip, to erect, construct, and/or bury, and to operate, replace, repair and maintain over, under or across said lands and in or upon all roads, streets or highways abutting or in any way adjoining said property, a utility system, in suitable structural and/or buried form, including the right to trim trees along said strip. The Grantor reserves the right to use and cultivate said property for all purposes not inconsistent with the rights herein granted.

This right, privilege and authority shall extend over, on or under such land of Grantor, as required, to furnish electrical service to other members (article I, Section 9, by-laws). To have and hold the same unto the said grantee and its successors and assigns forever.

Signed and sealed this _____ day of _____, 19____ at _____.

(Corporate Name)

By

Witness: _____

Its

STATE OF _____)

ss.

County of _____)

On this _____ day of _____, 19____, before me, the undersigned, a Notary Public in and for the State of _____, personally appeared _____, known to me to be the _____, of _____, the corporation that executed the foregoing instrument, and acknowledged to me that such corporation executed the same.

IN WITNESS WHEREOF, I have herunto set my hand and affixed my Notarial Seal the day and year in this certificate first above written.

Notary Public for the State of _____
Residing at _____
My Commission Expires _____

THIS SPACE FOR RECORDING INFORMATION

0109_01-001_010-120004 1/99